

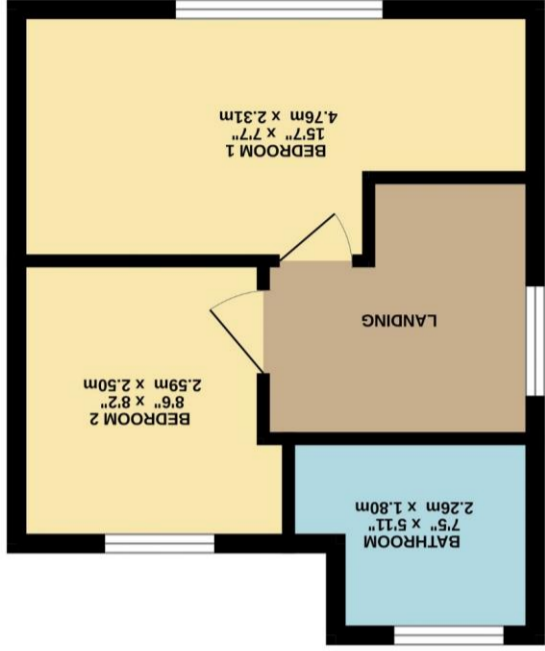

Whilst every attempt has been made to ensure the accuracy of the floorplan contained here, measurements of doors, windows, rooms and any other items are approximate and no responsibility is taken for any error. This plan is for illustrative purposes only and should be used as such by any prospective purchaser. The services, systems and appliances shown have not been tested and no guarantee as to their operability or efficiency can be given.
 Made with Metropix ©2024

TOTAL FLOOR AREA: 601 sq.ft. (55.8 sq.m.) approx.



1ST FLOOR
267 sq.ft. (24.8 sq.m.) approx.



GROUND FLOOR
333 sq.ft. (31.0 sq.m.) approx.



28 St. Jude Road, Bridlington, East Yorkshire,
YO16 7LB

Harris Shields
Collection

TWO BEDROOM SEMI DETACHED HOUSE - OFFERS IN THE REGION OF

- ✓ Semi Detached House.
- ✓ 2 Bedrooms.
- ✓ Gas Central Heating.
- ✓ UPVc Double Glazing.
- ✓ Rear Garden.
- ✓ Some TLC Required.
- ✓ No Onward Chain.
- ✓ Old Town Bridlington.

Offers in the region of £100,000

Harris Shields Collection

Harris Shields Collection, 14 Promenade, Bridlington East Yorkshire, YO15 2PX

01262 601704

estateagents@harris-shieldscollection.uk

<https://harris-shieldscollection.uk/>

Description

SEMI DETACHED HOUSE.....

Situated on the Western side of Bridlington, with open aspects over allotments to the rear, this property, which benefits from Gas Central Heating and UPVc Double Glazing briefly comprises: Lounge / Diner; Kitchen; 2 Bedrooms; Garden Room and Bathroom / WC. To the rear is an enclosed Garden.

Located close to our historic Old Town, with its varied cafes, galleries, tea rooms and shops, St Jude Road is the catchment area for Burlington Infant and Junior Schools, Our Lady & St Peters RC Primary and Bridlington Sports College.

The property would, in our opinion, benefit from some internal upgrading however may be of interest to first time buyers or investors looking for a Buy To Let. Offered with No Onward Chain.

Additional Information

Council tax band A



Opening doors
for over 60 years

Harris Shields
Collection